



## Markwick Terrace, St. Leonards-On-Sea TN38 0RE

Offers in excess of £185,000



A bright and spacious ONE BEDROOM APARTMENT set in one of St. Leonards MOST SOUGHT AFTER ADDRESSES forming part of this iconic terrace designed by Decimus Burton. It's located adjacent to PRIVATE RESIDENTS GARDENS and just a short distance from the beach and the hub of St. Leonards On Sea where there is a mainline railway station with connections to London. Enjoying far reaching SEA VIEWS, the accommodation here is set on the SECOND FLOOR and is arranged as a GENEROUS LIVING SPACE positioned at the front of the property which measures an impressive 17'2 x 11'10 offering plenty of room for a full dining table to create the ideal sociable setting while the FITTED KITCHEN is separate and provides ample storage space. The DOUBLE BEDROOM can be found at the rear of the property together with a bathroom which features a Japanese bathtub. Offering huge SCOPE FOR POTENTIAL and being sold with NO ONWARD CHAIN, this fantastic property would make the perfect first time home or seaside retreat and is not to be missed.

SECOND FLOOR  
497 sq.ft. (46.1 sq.m.) approx.

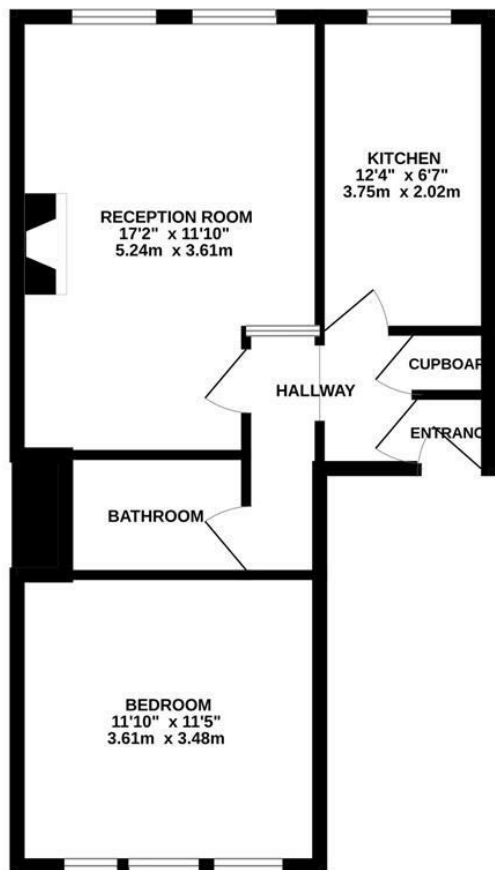

TOTAL FLOOR AREA : 497 sq.ft. (46.1 sq.m.) approx.

Whilst every attempt has been made to ensure the accuracy of the floorplan contained here, measurements of doors, windows, rooms and any other items are approximate and no responsibility is taken for any error, omission or mis-statement. This plan is for illustrative purposes only and should be used as such by any prospective purchaser. The services, systems and appliances shown have not been tested and no guarantee as to their operability or efficiency can be given.  
Made with Metropix ©2025

